

BO / KF

QUICK FORM KNURLING TOOLS

The BO form knurling tool is based on the same principle as type B2 and is characterized by high flexibility, stability and functional design. The special construction, which minimises vibrations and lateral pressure, is particularly suitable for machining small workpieces.



MODEL	PROD.-NO.	WORKPIECE Ø	KNURLING WHEEL mm (Ø x width x bore)
BO 8x8 L (one wheel)	P712-0241	1,2 - 12 mm	9,8 x 3,5x 5/6* (285)
BO 8x8 R (one wheel)	P712-0242	1,2 - 12 mm	9,8 x 3,5x 5/6* (285)
BO 10x10 L (one wheel)	P712-0243	1,2 - 12 mm	9,8 x 3,5x 5/6* (285)
BO 10x10 R (one wheel)	P712-0244	1,2 - 12 mm	9,8 x 3,5x 5/6* (285)
BO 12x12 L (one wheel)	P712-0245	1,2 - 12 mm	9,8 x 3,5x 5/6* (285)
BO 12x12 R (one wheel)	P712-0246	1,2 - 12 mm	9,8 x 3,5x 5/6* (285)

a	b	c	d	e	f	x
8	8	113	14,5	13	16,5	0,9
8	8	113	14,5	13	16,5	0,9
10	10	113	14,5	13	16,5	0,9
10	10	113	14,5	13	16,5	0,9
12	12	113	14,5	13	16,5	0,9
12	12	113	14,5	13	16,5	0,9

*DETAILS ABOUT KNURLING WHEELS (WHEEL PITCHES, TOOTH ANGLE ETC.) ARE LISTED ON PAGE 40/41.

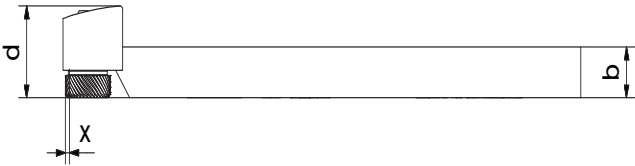

RIGHT-HAND TOOL VERSION WITH 1 KNURLING WHEEL
CUTTING SPEED AND FEED RATE INFORMATION, PAGE 43:

RGE45° (Cross):



1 x 45°L knurling wheel (forming) or
1 x 45°R knurling wheel (forming)

